

Распределитель SXO с алюминиевым корпусом

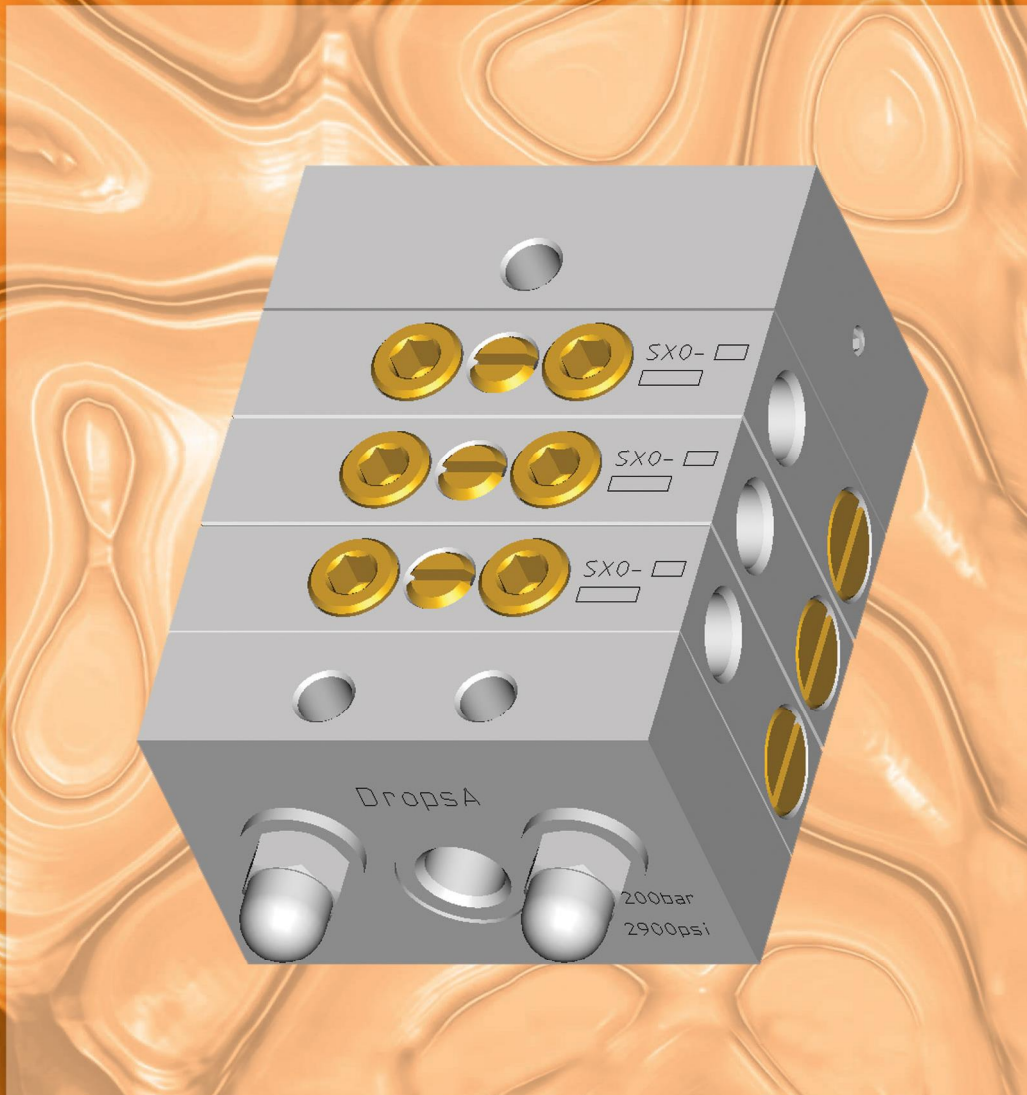

SERIAL SXO ALUMINIUM

Automatic Lubrication Systems

SXO

SXO

2	2	2	1	3 - 10	1			
			BSP 1/8	NPTF 1/8	c ³ (cu.in.)	BSP 1/8	NPTF 1/8	
16742	16291	3	644685	644695	0.05 (0.003)	644680	644690	644659
		4			0.10 (0,006)	644681	644691	
		5			0.15 (0,009)	644682	644692	
		6			0.20 (0,012)	644683	644693	
		7			0.25 (0,015)	644684	644694	
		8						
		9						
		10						

: .20 (290 psi) . 200 (2900 psi)
: 200

: 1

: .32 cSt (149 SUS)

. 2 NLGI (265-295 ASTM)

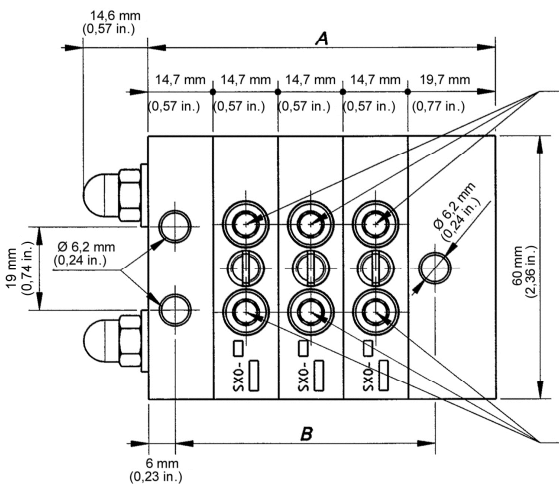
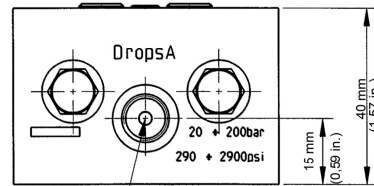
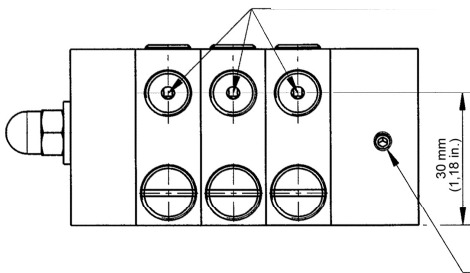

No. of Elem.	A mm (in.)	B mm (in.)
3	78,5 (3,09)	58,8 (2,31)
4	93,2 (3,66)	73,5 (2,89)
5	107,9 (4,24)	88,2 (3,47)
6	122,6 (4,82)	102,9 (4,05)
7	137,3 (5,40)	117,6 (4,62)
8	152,0 (5,98)	132,3 (5,20)
9	166,7 (6,56)	147,0 (5,78)
10	181,4 (7,14)	161,7 (6,36)

		3 cu.in.			
G 1/8+ UNI-ISO 228/1	SX0 05	0,05	0,003	644710	644735
	SX0 10	0,10	0,006	644711	644736
	SX0 15	0,15	0,009	644712	644737
	SX0 20	0,20	0,012	644713	644738
	SX0 25	0,25	0,015	644714	644739
1/8+ NPTF	SX0 05	0,05	0,003	644720	644740
	SX0 10	0,10	0,006	644721	644741
	SX0 15	0,15	0,009	644722	644742
	SX0 20	0,20	0,012	644723	644743
	SX0 25	0,25	0,015	644724	644744

500

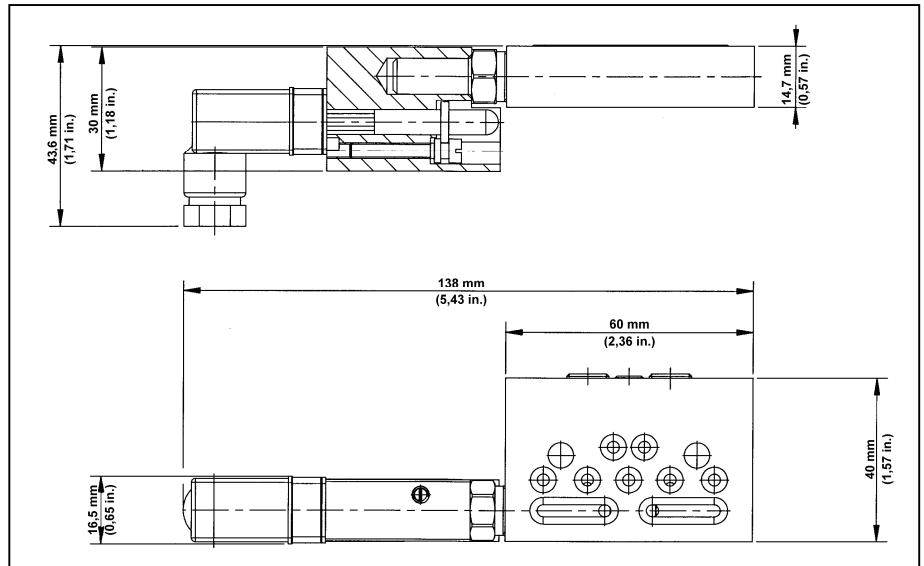
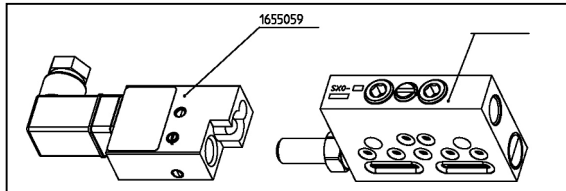

PIN

C

C

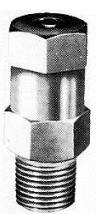
PIN			 31 (1,22 in.) .12 (0,47 in.)
psi		1/8 gas	
300	20	3290019	
450	30	3290006	
750	50	3290007	
1500	100	3290008	
2200	150	3290009	
2900	200	3290010	

			 43 (1,69 in.) .12 (0,47 in.)
psi		1/8 gas	
450	30	3290000	
750	50	3290001	
1100	75	3290022	
1500	100	3290002	
2200	150	3290003	
2900	200	3290004	

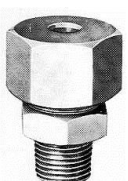
			 .28 (1,1 in.) .17 (0,67 in.)
psi		1/8 gas	
450	30	3290012	
750	50	3290013	
1500	100	3290014	
2200	150	3290015	
2900	200	3290016	

INOX		 38 (1,5 in.) .13 (0,51 in.)
1655210		
M12x1		

