



LIGHT ALLOY JUNCTIONS

This junction are produced from extruded from light alloy sections and have two fixing holes.

All holes are interconnected and threaded 5/16" – 24 NF with a 54° seating to suit compression cone **Part No. 93004** and bushing **Part No. 92009** (hex.8) or **92004** (hex.9).

Suitable only for 4 mm (5/32") tubing.

Junction meter units type D21 and DDJ may be screwed directly in the junction.

Junction of different length and fixing centres can be supplied to special order.

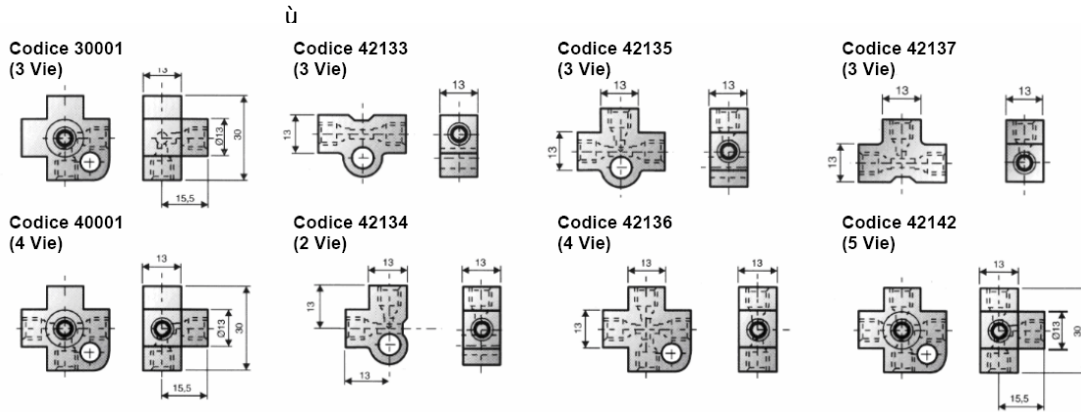

Part No. 4: **Codice 42426 8 way double row junction**

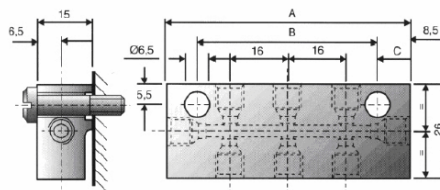

N° Vie	A	B	C	PESO	CODICE
6	50,3	33,3	8,65	0,038	0042425
8	66,2	49,2	8,60	0,050	0042426
10	82	65	8,50	0,062	0042427
14	116	99	9,5	0,090	0042428

Part No **Codice 42426 5 way double row junction**

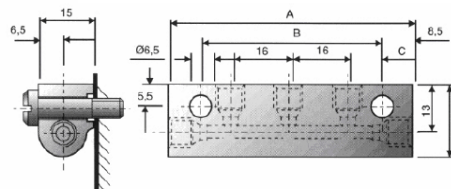

N° Vie	A	B	C	PESO	CODICE
4	50,3	33,3	8,65	0,038	0042125
5	66,2	49,2	8,60	0,050	0042126
6	82	65	8,50	0,062	0042127
7	98	81	8,50	0,054	0042128

Info distributore: