



CHARACTERISTICS

Number of outlets:

- 6 to 18

Dosing volume per outlet:

- 100 or 200 mm³

Ambient temperature:

- From 32 to 212 °F

Operating pressure:

- From 20 to 250 bar

Progressive distributor VF

Progressive distributor in block design available with up to 18 lubrication outlets.

The progressive distributor VF is suitable for central lubrication with fluid grease or grease.



TECHNICAL INFORMATION

General

| | |
|---------------------------------|-------------------------------------|
| Type | Block distributor |
| Lubrication line connection | M10x1 |
| Ambient temperature | From 32 to 212°F (from 0 to 100 °C) |
| Protection class as per EN60529 | IP 67 |

Hydraulic system

| | |
|--------------------|----------------------|
| Operating pressure | From 20 to 250 bar |
| Operating medium | Fluid grease, grease |
| Range of viscosity | NLGI 000- 2 |

Sensor system

| | |
|----------------------------|----------|
| Circulation control | |
| Switching voltage | 24 V DC |
| Switching current | ≤ 300 mA |
| Power consumption | ≤ 15 mA |
| Connection | M12 x 1 |

Mode of operation:

Every piston in the progressive distributor is displaced once per circulation into the two end positions. The displaced lubricant flows towards the respective outlet. Before the end position of the moving piston, the piston releases the lubricant to the next piston. Progressive distributors can pause in every position and restart. If an outlet is blocked, the progressive distributor stands still. This is a prerequisite for simple monitoring of individual progressive distributors or those connected in series. There must be a circulation control in the system for monitoring, which, for the purpose of controlling, must respond in a predetermined monitoring time.

Design:

Block design i.e. 1 piston for two outlets in a housing. The inlet for the main line H is on the front side of the housing. Outlets L and R are on the left and right of the housing, which are offset against the effective piston. Opposite outlets can be connected. If two outlets are connected one side has to be blocked and the remaining outlets dispense the double amount. The dosing volume for every outlet is specified in figures on the type plate. For details see order samples. Electrical circulation controls are available.

IDEAL FOR

- Central lubrication with fluid grease or grease

APPLICATIONS

- All machines
- Progressive lubrication with fluid grease or grease

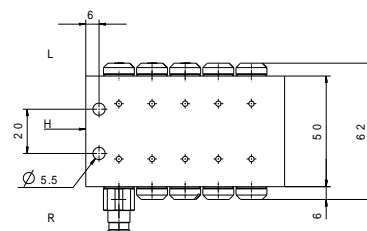
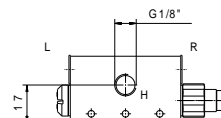
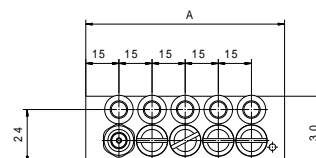
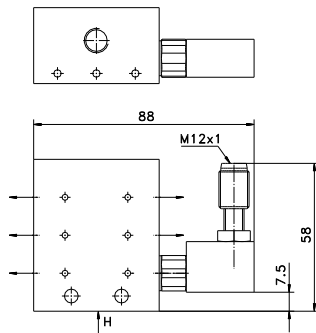

| Pistons | A [mm] |
|---------|--------|
| 3 | 60 |
| 4 | 75 |
| 5 | 90 |
| 6 | 105 |
| 7 | 120 |
| 8 | 135 |
| 9 | 150 |



ORDER NUMBER - CONFIGURATOR

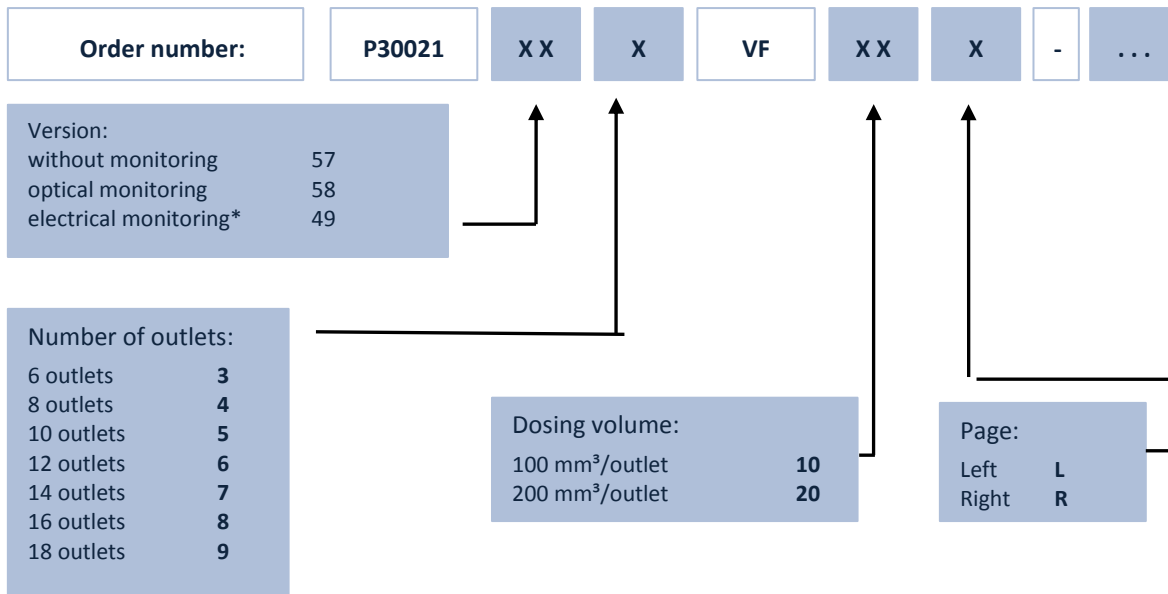

*incl. inductive proximity switch with cable M12 x 1, length 3m

The dosing volume of the outlets must be given starting from input H. This must be specified through the number 10 for 100 mm³ or 20 for 200 mm³. If the dosing volume is combined by removing the ball and the plug screw on an opposite side, the side must be mentioned. The side to be kept open should be specified through addition R or L as per the code. (R = Right; L = Left)

Order sample:

Progressive distributor 300 21 573 VF 10L-10-10

10 for 100 mm³

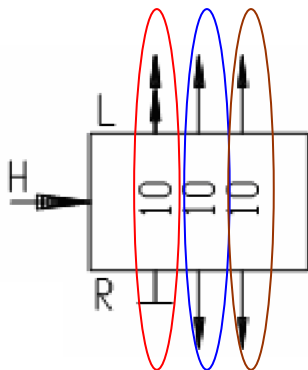

ORDER OVERVIEW

| Version | | Order number |
|-----------------------|------------|--------------|
| Without Monitoring | 6 Outlets | P30021573 |
| Without Monitoring | 8 Outlets | P30021574 |
| Without Monitoring | 10 Outlets | P30021575 |
| Without Monitoring | 12 Outlets | P30021576 |
| Without Monitoring | 14 Outlets | P30021577 |
| Without Monitoring | 16 Outlets | P30021578 |
| Without Monitoring | 18 Outlets | P30021579 |
| Optical Monitoring | 6 Outlets | P30021583 |
| Optical Monitoring | 8 Outlets | P30021584 |
| Optical Monitoring | 10 Outlets | P30021585 |
| Optical Monitoring | 12 Outlets | P30021586 |
| Optical Monitoring | 14 Outlets | P30021587 |
| Optical Monitoring | 16 Outlets | P30021588 |
| Optical Monitoring | 18 Outlets | P30021589 |
| Electrical Monitoring | 6 Outlets | P30021493 |
| Electrical Monitoring | 8 Outlets | P30021494 |
| Electrical Monitoring | 10 Outlets | P30021495 |
| Electrical Monitoring | 12 Outlets | P30021496 |
| Electrical Monitoring | 14 Outlets | P30021497 |
| Electrical Monitoring | 16 Outlets | P30021498 |
| Electrical Monitoring | 18 Outlets | P30021499 |