

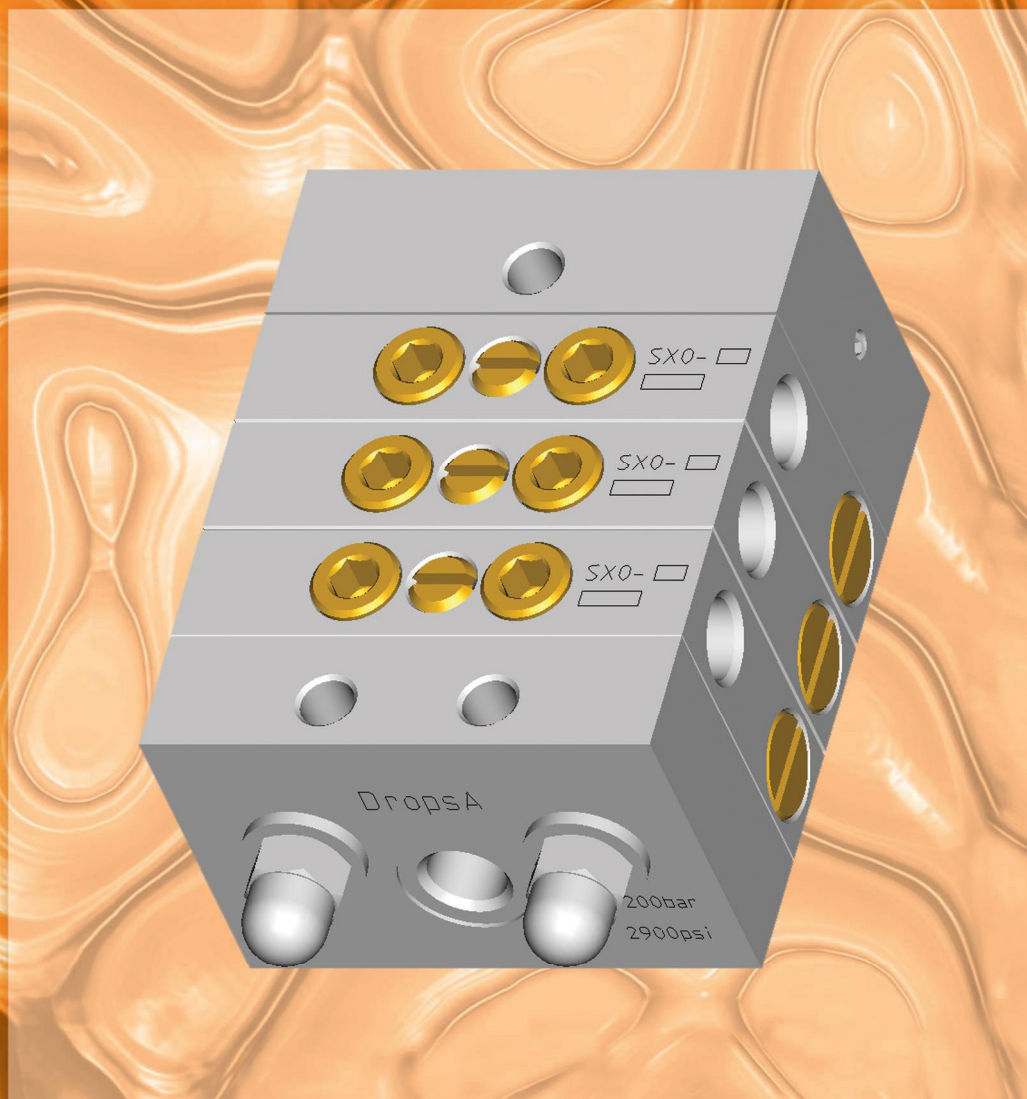

Прогрессивный питатель SXO, алюминиевый корпус



SERIAL SXO ALUMINIUM

Автоматические централизованные системы смазки

SXO

SXO

2	2	2		1		.3 - .10		1	
		N.		BSP 1/8	NPTF 1/8	c ³ (cu.in.)	BSP 1/8	NPTF 1/8	
16742	16291	3	644666	644685	644695	0.05 (0.003)	644680	644690	644659
		4	644667			0.10 (0,006)	644681	644691	
		5	644668			0.15 (0,009)	644682	644692	
		6	644669			0.20 (0,012)	644683	644693	
		7	644676			0.25 (0,015)	644684	644694	
		8	644677						
		9	644678						
		10	644679						

:
: .20 (290 psi) . 200 (2900 psi)
: 200
: 1
: .32 cSt (149 SUS) . .2 NLGI (265-295 ASTM)

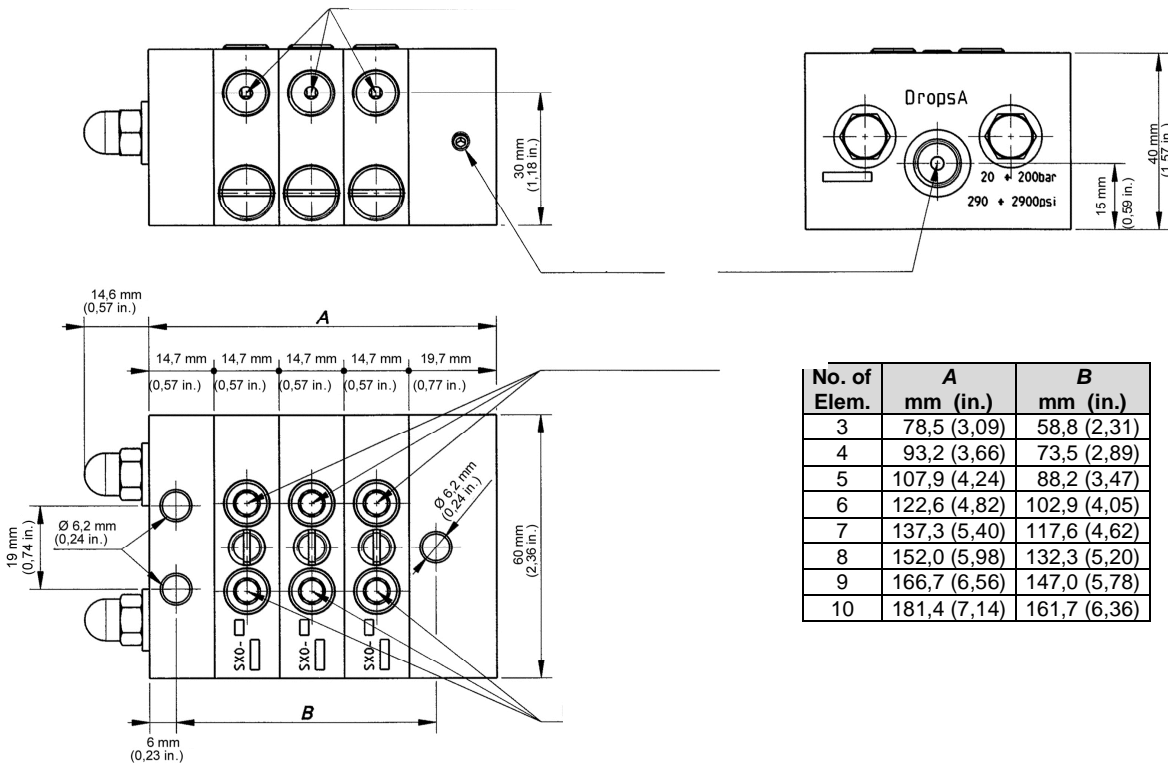

		3 cu.in.			
G 1/8+ UNI-ISO 228/1	SX0 05	0,05	0,003	644710	644735
	SX0 10	0,10	0,006	644711	644736
	SX0 15	0,15	0,009	644712	644737
	SX0 20	0,20	0,012	644713	644738
	SX0 25	0,25	0,015	644714	644739
1/8+ NPTF	SX0 05	0,05	0,003	644720	644740
	SX0 10	0,10	0,006	644721	644741
	SX0 15	0,15	0,009	644722	644742
	SX0 20	0,20	0,012	644723	644743
	SX0 25	0,25	0,015	644724	644744

500

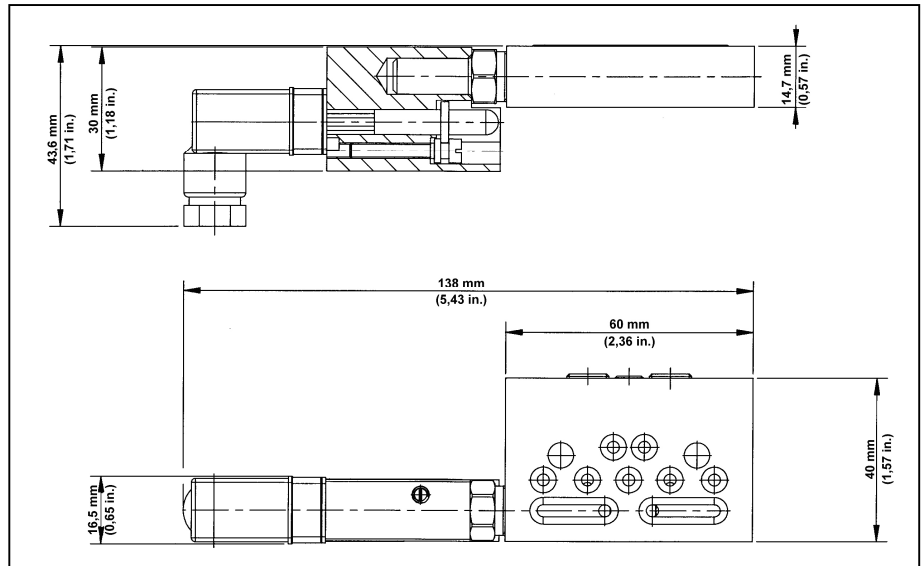
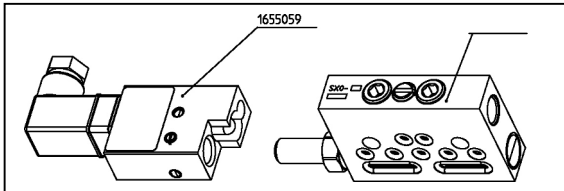

PIN

C

C

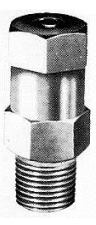
PIN			
psi		1/8 gas	
300	20	3290019	31 (1,22 in.) .12 (0,47 in.)
450	30	3290006	
750	50	3290007	
1500	100	3290008	
2200	150	3290009	
2900	200	3290010	

			
psi		1/8 gas	
450	30	3290000	43 (1,69 in.) .12 (0,47 in.)
750	50	3290001	
1100	75	3290022	
1500	100	3290002	
2200	150	3290003	
2900	200	3290004	

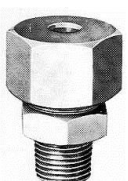
			
psi		1/8 gas	
450	30	3290012	.28 (1,1 in.) .17 (0,67 in.)
750	50	3290013	
1500	100	3290014	
2200	150	3290015	
2900	200	3290016	

INOX		
1655210		38 (1,5 in.) .13 (0,51 in.)
M12x1		



CHARACTERISTICS	FITTING (R)						BRIDGE ELEMENT										
	A	B	C	Ch	L	tube C	Ch	L	H	I	Part No.	Ch	L	H	I	Part No.	
BSP	1/8	1/8	1/8	12	36,5	6	640999	12	29	14	14,7	640041	12	29	23,5	14,7	640061
NPTF	1/8	1/8	1/8	12	34,5	—	640101	12	29	18,5	14,7	643156	12	29	23	14,7	643158

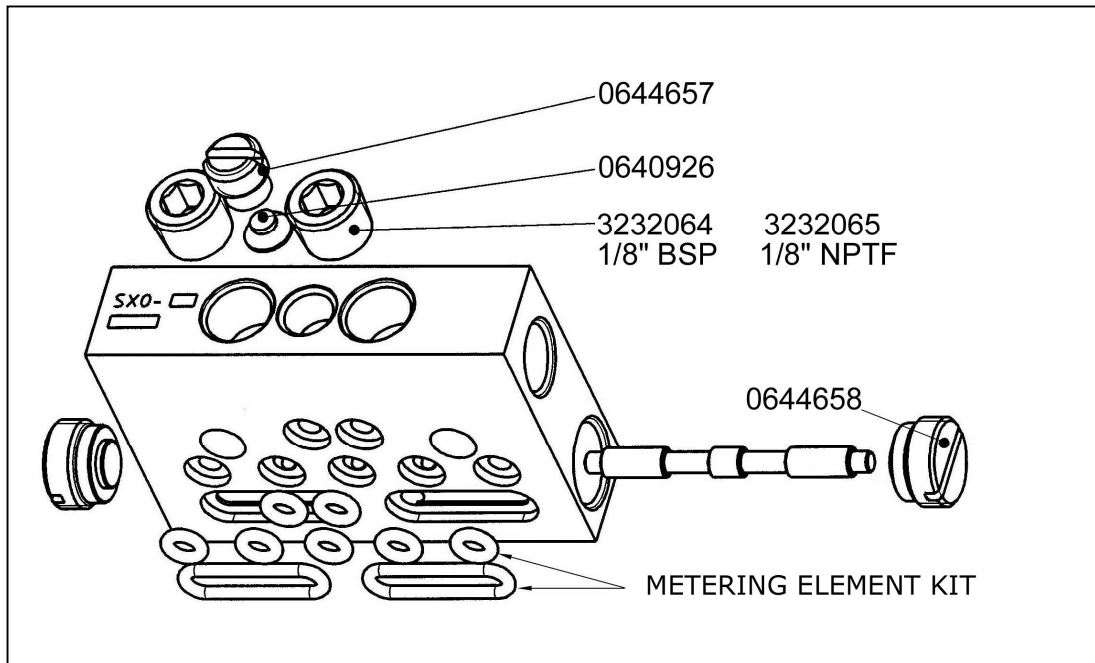
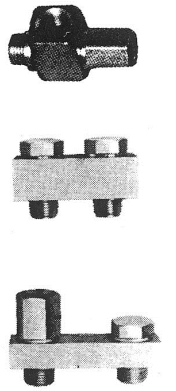

1 O Ring" :

0640817
0640816

(0640926).

(3232064 - 3232065)

ITALIA
Dropsa SpA
t. +39 02-250791
f.+39 02-25079767

U.K.
Dropsa (UK) Ltd
t. +44 (0)1784-431177
f. +44 (0)1784-438598

GERMANY
Dropsa GmbH
t. +49 (0)211-394-011
f. +49 (0)211-394-013

FRANCE
Dropsa Ame
t. +33 (0)1-3993-0033
f. +33 (0)1-3986-2636

CHINA
Dropsa Lubrication Systems
(Shanghai) Co., Ltd
t. +86 (021) 67740275
f. +86 (021) 67740205

U.S.A.
Dropsa USA Incorporated
t. +1 586-566-1540
f. +1 586-566-1541

AUSTRALIA
Dropsa Australia Pty
t. +61 (02)-9938-6644
f. +61 (0)2-9938-6611

BRAZIL
Dropsa Do Brasil Ind.e
Com.Ltda
t. +55 (0)11-563-10007
f. +55 (0)11-563-19408

Web site:
<http://www.dropsa.com>

E-mail:
sales@dropsa.com

WK 39/06
C2091PR