

## CHARACTERISTICS

- **EASY MAINTENANCE:** THE MODULAR ELEMENT MOUNTED ONTO THE BASE CAN BE REPLACED QUICKLY AND EASILY; IT IS NOT NECESSARY TO REPLACE THE ENTIRE SUPPLY UNIT.
- **REDUCTION OF SPARE PARTS, FEWER COMPONENTS = REDUCTION OF INVENTORY COSTS.**
- **SUBSTANTIAL SAVINGS ON LABOUR COSTS**
- **MAINTENANCE OF METERING VALVES CAN BE DONE WITHOUT AFFECTING THE EXISTING PIPEWORK.**
- **VERY LOW MAINTENANCE COSTS:** THE MODULARITY CONCEPT WILL BE ABLE GUARANTEE LOW RESTORATION COSTS OF THE COMPONENTS.
- **FLEXIBILITY IN THE ABILITY TO INCREASE OR DECREASE THE NUMBER OF ELEMENTS TO SUIT YOUR NEEDS.**

## DM X-OVER SUB-BASE

### THE EASIEST WAY TO MODULARISE YOUR EXISTING TRADITIONAL DUAL-LINE SYSTEM

Using the **DM X-OVER** modular valves, customers who already use traditional non-modular dual-line products can pass over to a modular design without difficulty and immediately take advantage of the many benefits that this includes.



#### THE DM X-OVER CONSISTS OF TWO MAIN PARTS:

- **Modular valves in a variable number from 1 to 4**
- **1 interchangeable base with traditional dual-line systems**

Modular valves can be assembled on the designated base up to obtaining a number of eight outlets.

The DM standard modular metering valves can be used with fixed or adjustable discharge outlet. Adjustable discharge valves are equipped with turrets, integral adjustment screws, a methacrylic cover and a gasket.

A locking plate (to be ordered separately) makes it possible for additional lubrication points to be introduced.

The **DM X-OVER**-series base plates allow the user to replace non-modular dual-line elements (generally 1-4 turrets) with a new base that has the same connections of the pipes that can be interchanged with existing similar non-modular ones, **DD-42** or **DD 52**.

**NEW SUB-BASE PLATE**

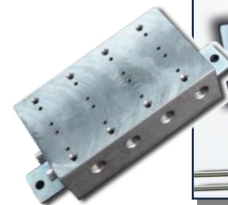

**NON-MODULAR DUAL-LINE COMPONENTS**



The **SUB-BASE PLATE** accommodates the **DROPSA MODULAR VALVES**. Once the plate is positioned, the dual-line valves can be replaced without having to touch the pipes again.



**NEW SUB-BASE PLATE WITH MODULAR ELEMENTS**

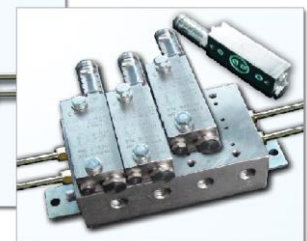

**DM DROPSA DUAL-LINE VALVES ARE THE PREFERRED CHOICE OF MANY OEMS AND CUSTOMERS IN THE STEEL SECTOR FOR GREASE LUBRICATION VALVES.**

**THE PRODUCT PROVIDES HIGH RELIABILITY AND EXCELLENT VALUE FOR MONEY.**

*Let us consider some important factors concerning Dropsa dual-line modular valves:*

- Made of high-quality nickel-plated steel, 70 times more resistant than galvanised steel;
- Also available in 316 stainless steel for very difficult environments;
- Micron level grinding and rectification production process for high performance;
- Viton seal technology designed specifically to be long-lasting without loss, even when oil is used instead of grease;
- Manufactured and assembled at our technologically advanced plant and individually tested to ensure quality standards;
- CE and ATEX standard certification

## APPLICATIONS

- **ANY TRADITIONAL DUAL-LINE CYLINDER BLOCK SYSTEM**

## DIMENSIONS (SCALE 1:2)

**1 MODULE**

**0673161**

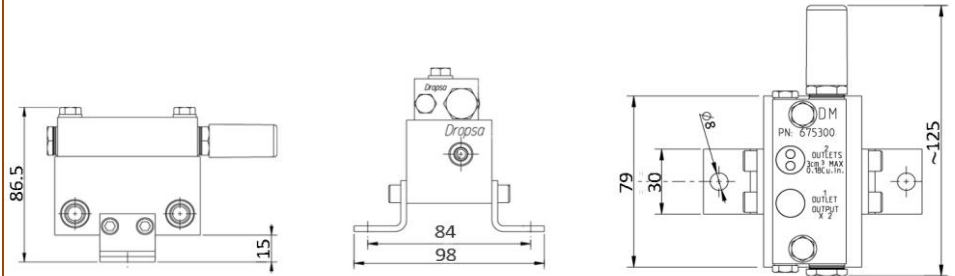
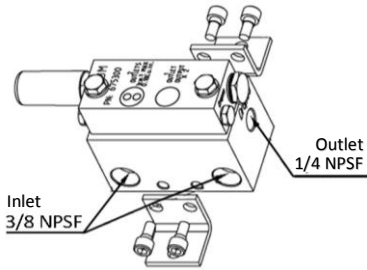

**2 MODULES**

**0673162**

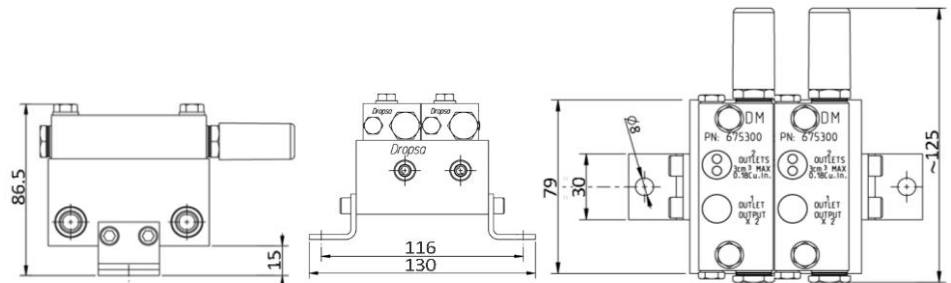
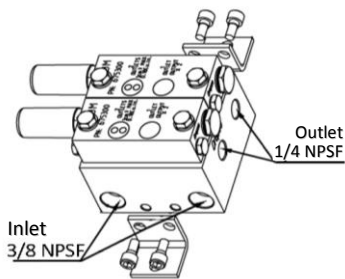

**3 MODULES**

**0673163**

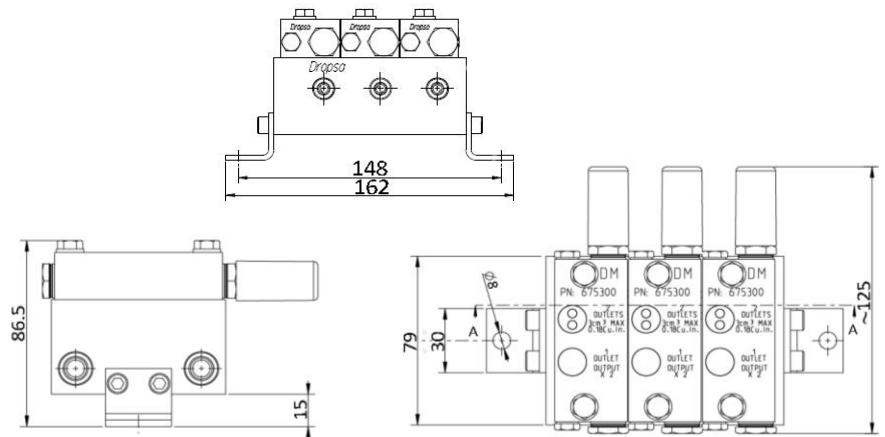
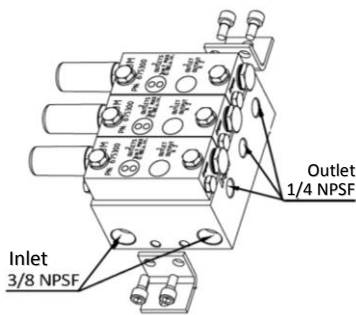

**4 MODULES**

**0673164**

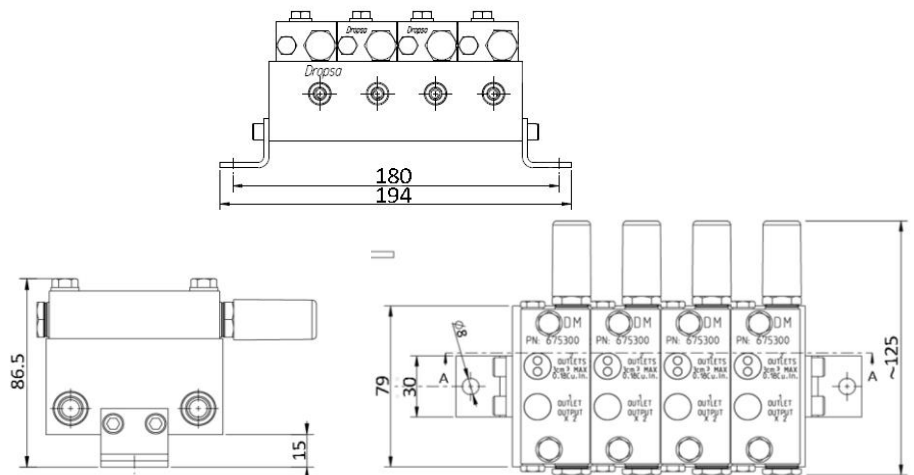
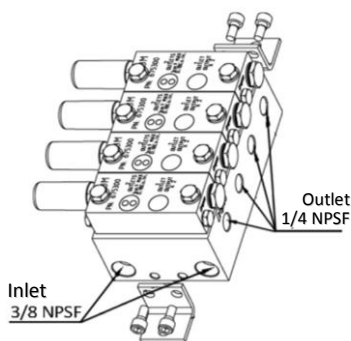

**1 MODULE**      **0673171**

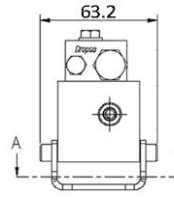
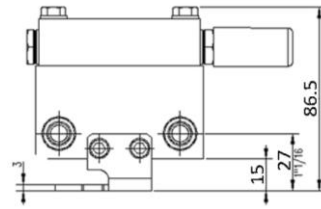
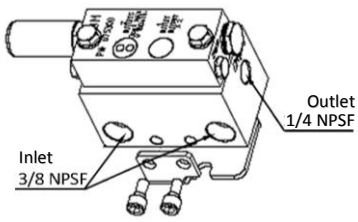

**SECTION A-A**

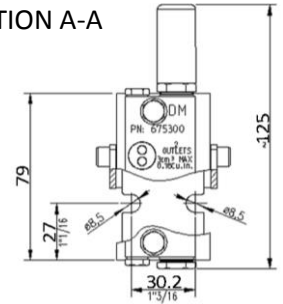

**2 MODULES**      **0673172**

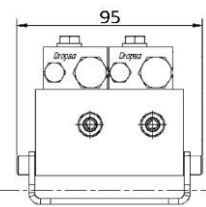
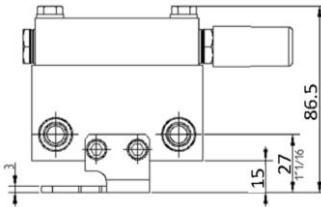
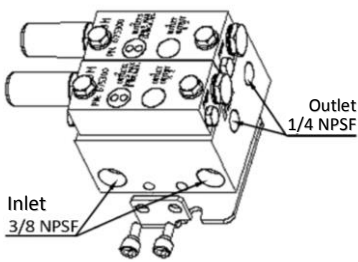

**SECTION A-A**

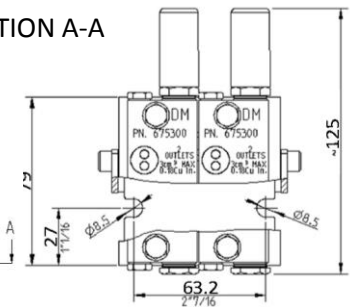

**3 MODULES**      **0673173**

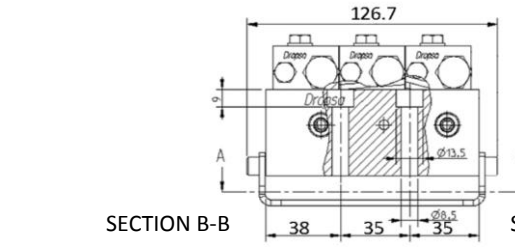
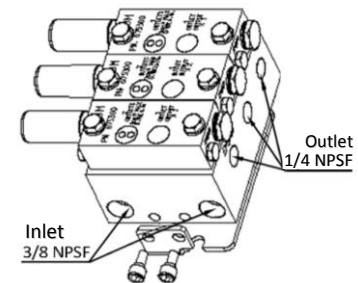

**SECTION B-B**

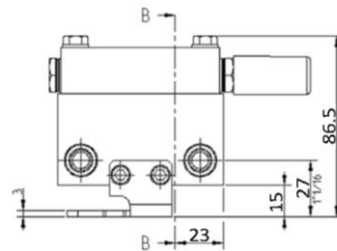

**SECTION A-A**

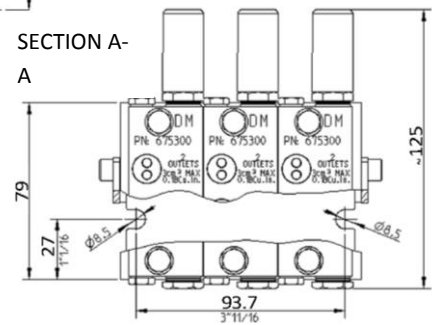

**4 MODULES**      **0673174**

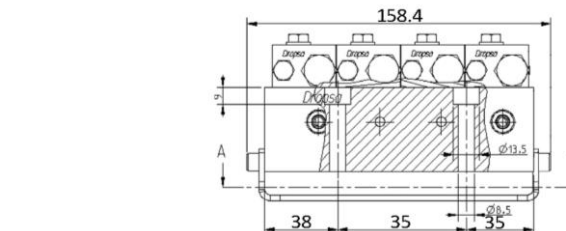
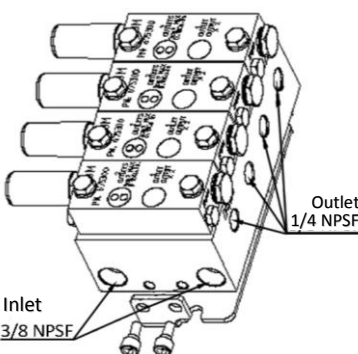

**SECTION B-B**

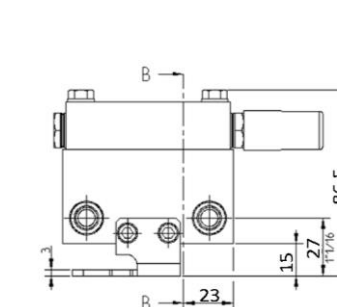

**SECTION A-A**

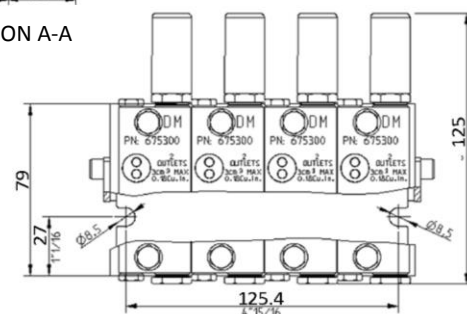



## TECHNICAL INFORMATION

### TECHNICAL CHARACTERISTICS

Lubricant	Oil: 100 cST - grease: Max: 265 ASTM (NLGI2)
Operating temperature	-30 ÷ + 80 °C (-22 ÷ +176 Fahrenheit)
Maximum input pressure	400 bar
Frequency	100 cycles / minute
Connections	Inlets: 3/8" NPSF - outlets: 1/4" NPSF
Flow rate	From 0.25 cc to 3 cc

## ORDER INFORMATION

### BASIC MODELS

DESCRIPTION	PART NUMBER
DM X-OVER modular valves 1-2 outlets	0673161
DM X-OVER modular valves 2-4 outlets	0673162
DM X-OVER modular valves 3-6 outlets	0673163
DM X-OVER modular valves 4-8 outlets	0673164
DM X-OVER modular valves 1-2 outlets	0673171
DM X-OVER modular valves 2-4 outlets	0673172
DM X-OVER modular valves 3-6 outlets	0673173
DM X-OVER modular valves 4-8 outlets	0673174

### KIT + DIVIDER

DESCRIPTION	PART NUMBER
Basic kit + divider, 1-2 outlets	3133551
Basic kit + dividers, 2-4 outlets	3133552
Basic kit + dividers, 3-6 outlets	3133553
Basic kit + dividers, 4-8 outlets	3133554

### SPARE PARTS

DESCRIPTION	PART NUMBER
02 mod-valve, modular 3cc AVP	675300
Bracket kit + screws for 673171	3133541
Bracket kit + screws for 673172	3133542
Bracket kit + screws for 673173	3133543
Bracket kit + screws for 673174	3133544
Bracket kit + screws for 673161-4	3133545