

CHARACTERISTICS

- **SMALL:**
SMALLEST SENSOR MEANS EASIER INSTALLATION ON TRICKY MACHINERY
- **RIALABLE:**
COMPLETELY SOLID STATE OPERATION HIGH RELIABILITY AND DURABILITY
- **NPN E PNP:**
BOTH INCLUDED AS STANDARD
- **M12 CONNECTOR:**
AUTOMOTIVE SPECIFICATIONS PROVIDES ROBUST WIRING SOLUTIONS

FLOW SENSOR

The "flow sensor" is particularly suitable to check oil passage into the pipes on systems with pump cyclic flow rate.

The passage of oil is detected by a reed switch activated by a magnet placed on a piston moved by fluid pressure.

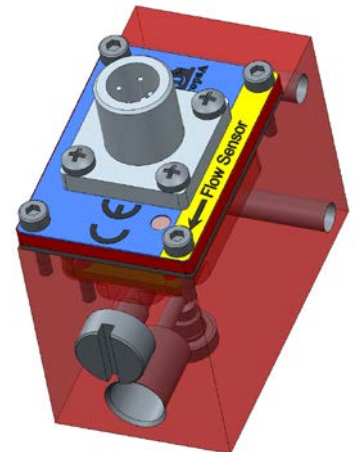

OPERATING PRINCIPLE

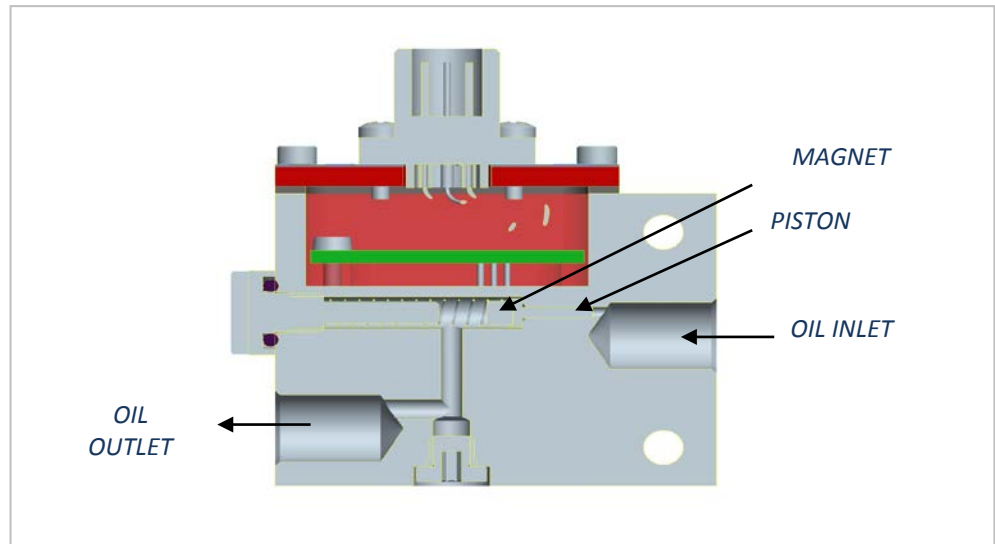

DIMENSIONS

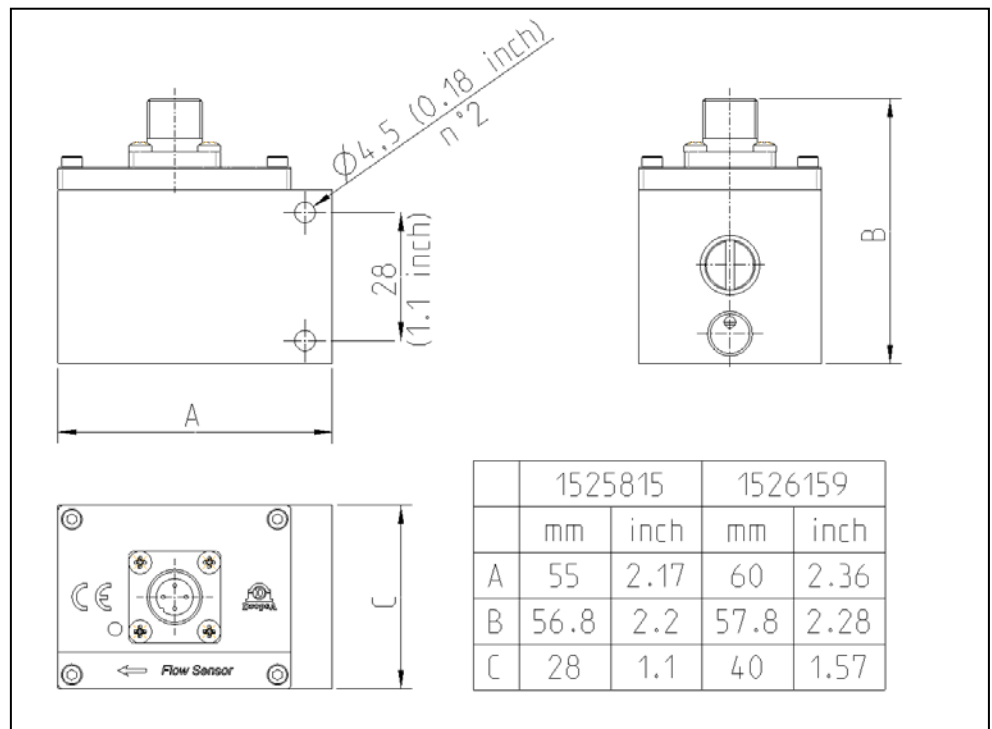

APPLICATION

- **LOW PEWSSURE OIL SYSTEMS WITH PULSES CYCLE**

TECHNICAL INFORMATION

TECHNICAL CHARACTERISTICS	
Material	Anodized aluminium
Readable Minimum flow rate reading	10 mm ³ /supply
Maximum cycles/min detectable	20 cycle/32 cSt min with oil 6 cycle /220 cSt min with oil
Voltage	8 ÷ 28 V DC
Short circuit protection	Yes
Protection degree	IP 65 – IP 67
Operating temperature	-5 °C ÷ +55 °C (23 °F ÷ +131 °F)
Connector	M12x1
Output signals	NPN 2A N.O - PNP 0,7A N.O.
Maximum pressure allowable	7 bar
Lubricant admitted	Oil: 32÷220 cSt
Inlet/output connection	1/8" BSP
Weight	0.2 Kg (0.44 lb)

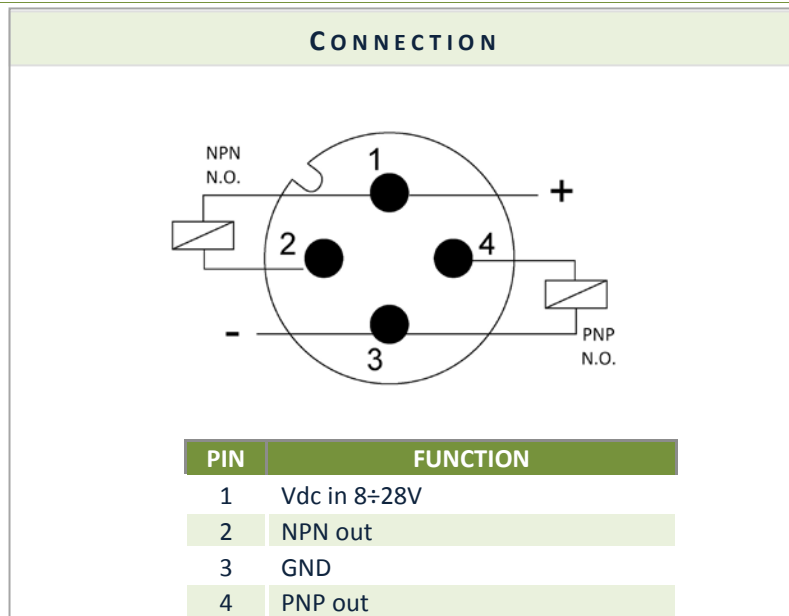

M12 connector - (top view)

ORDERING INFORMATION

FLOW SENSOR	
Description	Part Number
Flow sensor IP 65	1525815
Flow sensor IP 67	1526159

SPARE PARTS	
Description	Part Number
Electronic board assembly	3133490
Needle for sensor	1524594
Magnet	1524417
O-ring gasket	0018804
Spring for sensor	3191281
M5 plug	3234291

Distributor Info: