

AB-P

SINGLE PISTON PUMP



CHARACTERISTICS

Max pressure:
- 60 bar (870 psi)

Tank capacity:
- 1.2 / 3.0 litres

IDEAL FOR

- Daily or up to each minute oil lubrication
- Metering valves and dosing valves

APPLICATIONS

- Small machines in the industry
- Machine tools, wood processing, general industry
- Single point lubrication with oil or grease
- No UL approval required

AB-P SINGLE PISTON PUMP

The single piston pump AB-P is a robust pneumatic pump. It is suitable for automatic lubrications, which must be done several times daily to maximum once per minute.



TECHNICAL INFORMATION

General

Type	Single piston pump
Lubrication line connection	Pipe connection Ø 6 mm
Ambient temperature	0 to 80 °C
Filling	manual or filling device
Protection class as per EN60529	IP67

Hydraulic system

Operating pressure	60 bar (870 psi)
Flow rate	10.5 cm ³ /stroke
Pressure Ratio	P2=9,5x(P1-1,2)
Operating medium	Mineral oil
Range of viscosity	50 to 750 mm ² /s

*as per fluid grease release list

Drive

Type of drive	pneumatic
Supply pressure	4 to 6 bar
Supply fitting	G¼ "

Sensor system

Level control	
Switching voltage	24 V AC/DC
Switching current	≤100 mA (≥5 mA)
Connection	M12 x 1
	1 – L+ 4 – NC (Opens at low level)



TECHNICAL INFORMATION

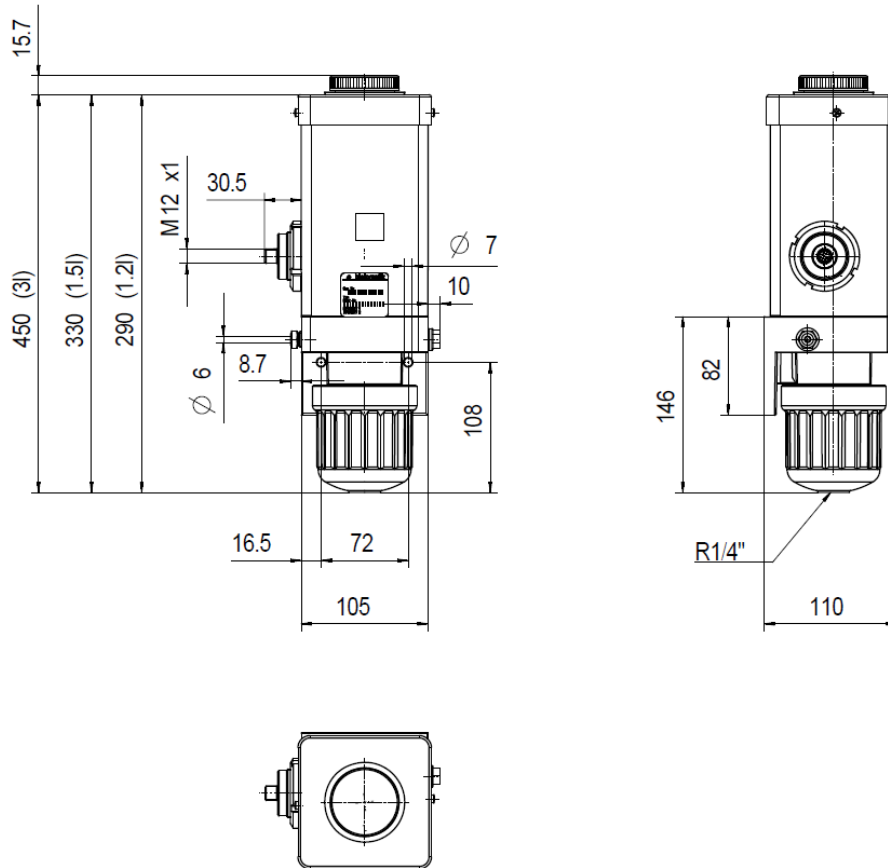

Order summary

Container Size [l]	Filling connection	Level control	Screw cap	Order number
1,2	no	no	no	P30011540
1,2	no	yes	no	P30011556
1,2	no	yes	yes	P30011565
3,0	no	no	no	P30011541
3,0	no	yes	no	P30011557

Spare Parts

Accessory Parts

Order number	Designation	Order number	Designation
P30400600	Cap	P62004053	Retaining screw
P30215201	Double taper ring	P62050004	Locking washer
P30256621	Male fitting	P30023403	3/2 directional control set, 24 V DC, 3 W
P30039041	Screw cap	P30023404	3/2 directional control set, 230 V AC, 6.5 VA
P30200659	Disc	P67202034	Connector cable 5m, cable box; for level control
P30050085	Tank filter		